

Soils Map

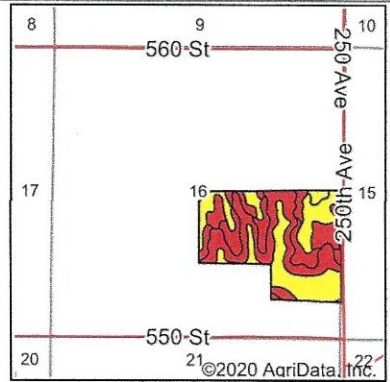

State: **Iowa**
 County: **Lucas**
 Location: **16-73N-21W**
 Township: **English**
 Acres: **98.5**
 Date: **8/20/2020**

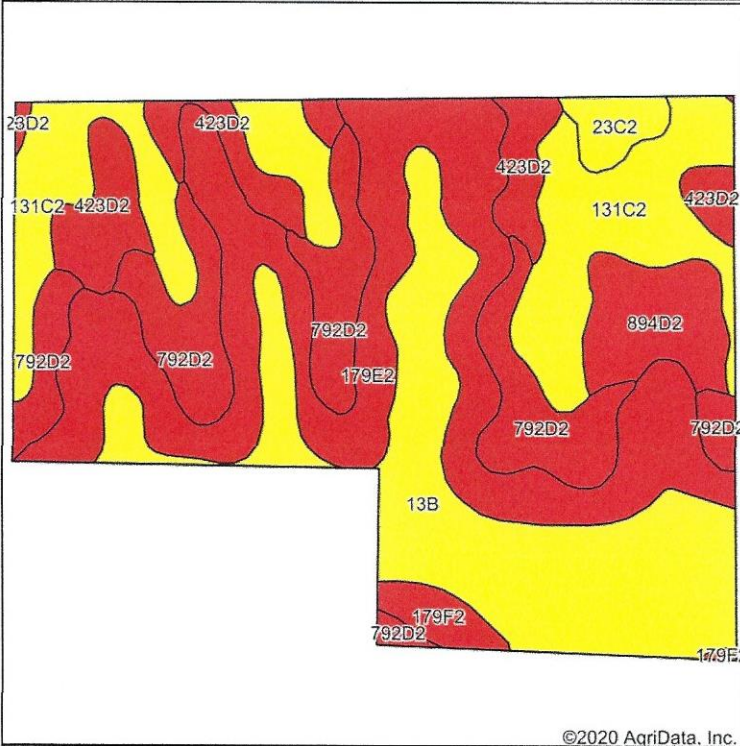







Maps Provided By:

 CUSTOMIZED ONLINE MAPPING
 © AgriData, Inc. 2020 www.AgriDataInc.com



Soils data provided by USDA and NRCS.

Area Symbol: IA117, Soil Area Version: 29

Code	Soil Description	Acres	Percent of field	CSR2 Legend	Non-Irr Class *c	CSR2**	CSR	*n NCCPI Soybeans
179E2	Gara clay loam, 14 to 18 percent slopes, moderately eroded	26.77	27.2%			Vle	23	33
13B	Zook-Olmitz-Vesser complex, 0 to 5 percent slopes	22.24	22.6%			llw	68	53
131C2	Pershing silty clay loam, 5 to 9 percent slopes, moderately eroded	17.95	18.2%			llle	62	45
792D2	Armstrong clay loam, 9 to 14 percent slopes, moderately eroded	14.91	15.1%			IVe	5	13
423D2	Bucknell silty clay loam, 9 to 14 percent slopes, moderately eroded	8.49	8.6%			IVe	6	13
894D2	Bucknell-Gara complex, 9 to 14 percent slopes, moderately eroded	4.81	4.9%			IVe	22	24
23C2	Arispe silty clay loam, 5 to 9 percent slopes, moderately eroded	1.68	1.7%			llle	62	50
179F2	Gara clay loam, 18 to 25 percent slopes, moderately eroded	1.65	1.7%			IVe	11	13
Weighted Average						36.5	34.5	*n 52.7

**IA has updated the CSR values for each county to CSR2.

*n: The aggregation method is "Weighted Average using all components"

*c: Using Capabilities Class Dominant Condition Aggregation Method