

(Landowners)  
CEDAR TWP

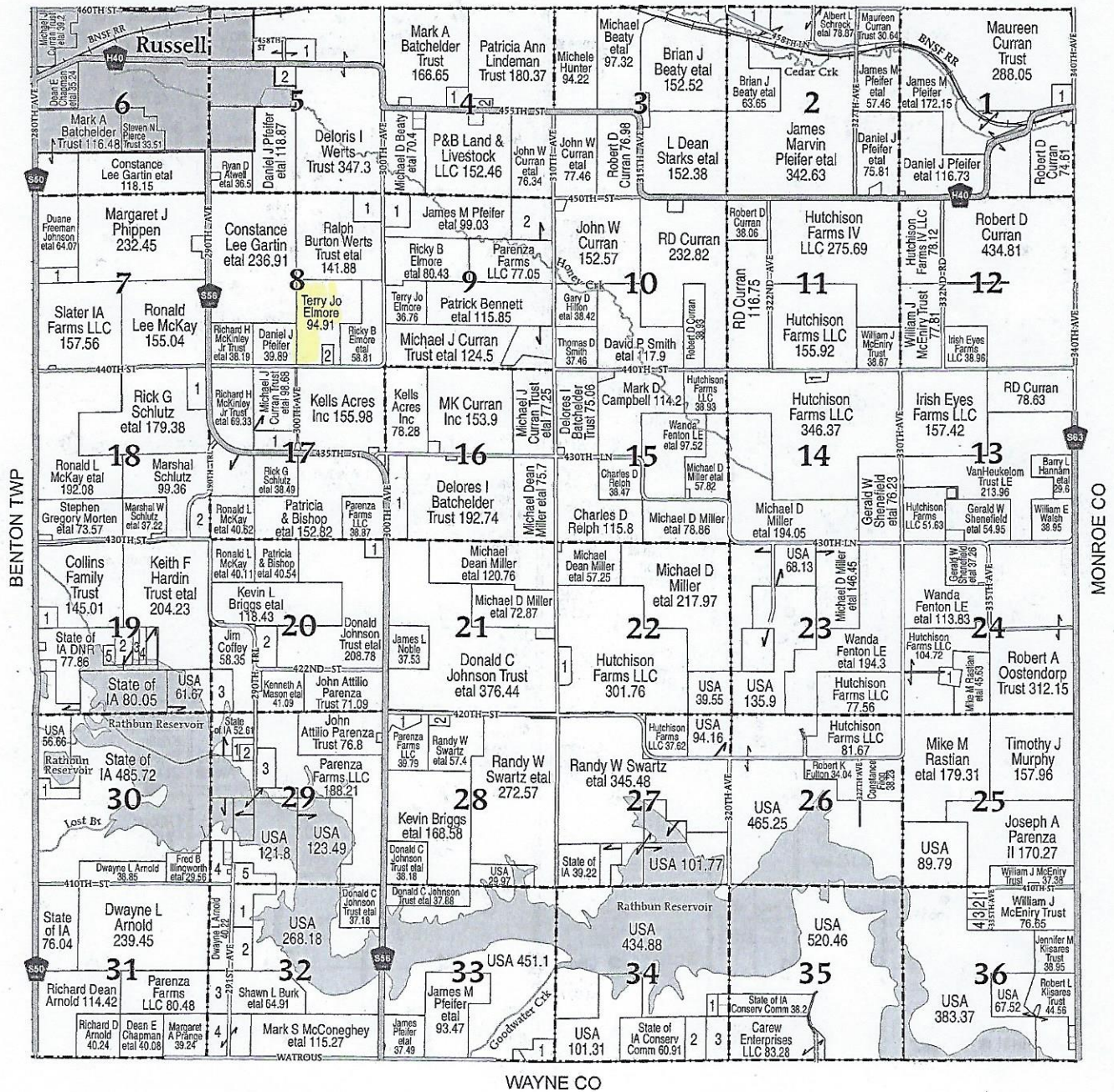

WASHINGTON TOWNSHIP	
SECTION 1	1 MOORE, JOSEPH F 9.95
SECTION 2	1 SANDY, DEREK ROY 13.26
SECTION 3	1 SCHRECK, ALBERT L ETAL 18.85
SECTION 4	1 CAVANAUGH III, JOHN F ETAL 10.1 2 CURRIE, KELLY ETAL 5.55
SECTION 5	1 STANSBERRY, CRAIG A ETAL 29.76 2 RUSSELL CEMETERY 9.71
SECTION 7	1 TANNER, KEVIN G ETAL 13.59

SECTION 8	
1 WERTS, BRUCE A ETAL	17.58
2 KECK ENTERPRISES LLC	5.23
SECTION 9	
1 WERTS TRUST, RALPH BURTON ETAL	18.65
2 CURRAN, JOHN W ETAL	68.8
SECTION 14	
1 CHANDLER, LOGAN DEAN	5.04
SECTION 16	
1 DAVIDSON, SHAWN G ETAL	33.64
SECTION 17	
1 BLUE, JEREMY J	18.23
SECTION 18	
1 MCKINLEY JR TRUST, RICHARD H ETAL	19.21
2 MCKAY, RONALD L ETAL	17.88

SECTION 19	
1 DUNSMOOR, GEORGE ROSS ETAL	9.27
2 NADLER TRUST, DAVID LEE ETAL	22.92
3 WILLIAMS, PAUL ARNOLD	5.06
4 CARVER, STEVE	5.68
5 GAY, JOSEPH H	5.04
SECTION 20	
1 JOHNSON, MARK GENE	7.77
2 SCHLUTZ, RICK G ETAL	19.47
3 MCKENZIE, SCOTT P	20.2
SECTION 22	
1 SHENEFIELD TRUST, PHIL	10.74
SECTION 24	
1 ATWELL, DONALD L ETAL	7.8
SECTION 28	
1 EASH, TERI L	10.1
2 SWARTZ FAMILY FARMS LLC	5.22

SECTION 29	
1 YEOMAN, WESLEY E ETAL	5.52
2 KRUMM, BRIAN	5.13
3 KRUMM, BRIAN C	16.91
4 ILLINGWORTH, FRED B ETAL	14.93
5 DRAKE, SHERRY	13.57
SECTION 30	
1 RUSSELL SPORTSMAN CLUB	12.86
SECTION 32	
1 DRAKE, SHERRY	23.56
2 ARNOLD, JAMES R ETAL	18.88
3 PARENZA FARMS LLC	19.61
4 PRANGE, MARGARET A	38.39
SECTION 33	
1 GARRISON, RANDY L ETAL	13.61
SECTION 34	
1 HEARL, BRIAN CHRISTOPHER	5.08

2 STATE OF IA DNR	19.67
3 CAREW ENTERPRISES LLC	20.99
SECTION 36	
1 SMITH, JAY L	5.35
2 HAZELWOOD, JAMES D	5.25
3 HAZELWOOD, JAMES	5.06
4 HOLLAND, PATRICK J ETAL	5.23

